

MW116

MEDICAL 60-90 WATT SERIES



#3 Connector pictured

MW116 SWITCH-MODE POWER SUPPLY

- 100-240 VAC Universal Input
- Desktop Style
- Single Output to 90W
- Regulated Output With Low Ripple
- Meets Medical Safety Agency Requirements
- Complies With EMI/RFI Regulations
- CE Compliant
- Impact Resistant Polycarbonate Enclosure
- Private Label Marking Available
- 3 Year Warranty
- Modified and Custom Designs Also Available

MW116

Ault Part No.	Voltage DC	Max Amps	Max Watts
MW116XA05XX_01	5V	12.0	60.0
MW116XA06XX_01	6V	10.0	60.0
MW116XA09XX_01	9V	7.80	70.0
MW116XA12XX_01	12V	6.67	80.0
MW116XA14XX_01	13.5V	6.15	83.0
MW116XA15XX_01	15V	6.00	90.0
MW116XA16XX_01	16V	5.60	90.0
MW116XA18XX_01	18V	5.00	90.0
MW116XA24XX_01	24V	3.75	90.0
MW116XA48XX_01	48V	1.87	90.0

Ault Part No. Key

Product Family Name	Manufacturing Location (volume dependent)	Design Revision Changes	Voltage DC	Connector #51 - Standard 16V and under; #3 - Standard 18V and over	Input Configuration/ Model Type (see pg. 2)	Denotes standard or custom requirements
PW116	X	A	05	XX	—	01



AULT INCORPORATED

7105 Northland Terrace | Minneapolis, Minnesota 55428 | USATEL (1) 763-592-1900

FAX (1) 763-592-1911 | E-MAIL info@aultinc.com | WEB www.aultinc.com

© Copyright 2002 Ault Inc.

MW116

MEDICAL 60-90 WATT SERIES

Input

Voltage	100-240 VAC -10%, +10%
Line Frequency	47 - 63 Hz
Current	2.0A max. at 90 VAC input
Protection	Internal primary current fuse, Inrush limiting
Power Factor Correction	Complies with EN61000-3-2 and EN61000-3-3

Output

Combined Line and Load Voltage Regulation	±1% excluding cord
Ripple	1% V p-p max
Transient Response	0.5 msec. for 50% load change typical
Holdup Time	16 msec min. over entire input range
Protection	Foldback overcurrent protection Short circuit protection
Cord and Connector	5V and 6V: 6 ft, 6 conductor, 18 AWG, Ault #51 connector. Pinout: Pins 4, 5, 6=+5; 1,2,3=common. 9V, 12V, 13.5V, 15V, 16V: 6 ft, 4 conductor, 18 AWG, Ault #51 connector. Pinout: Pins 1,4=+V; 3,6=common. All with overmolded Ferrite core. 18V, 24V, 48V,: 6 ft, 2 conductor, 18 AWG with overmolded Ferrite core, Ault #3 connector, center positive.

Safety Approvals

Agency Listings	TUV EN60601-1; cURus 2601; Australian, Japanese certification available - extra fees apply
-----------------	--

Input Configuration



IEC320
w/ground
C14
(F)



IEC320
w/o ground
C18
(Q)

In case IEC320 type: F=Class I C14 inlet Q=Class II C18 inlet
Specify the Input Configuration Code in your order.

Electrical

Topology	Switching - Fixed frequency 100KHz
Dielectric Withstand	4000 VAC, 5656 VDC primary-secondary 1500 VAC, 2121 VDC primary-ground 500 VAC, 707VDC secondary-ground
Spacing	8.0mm primary-secondary
Efficiency	Up to 89%
EMI	Complies with EMC Directives
CE	CE Compliant
MTBF	100,000 Calculated Hours Minimum

Environmental

Operating Temperature	0° to 40° C with no derating
Storage Temperature	-30° to +85° C
Relative Humidity	5% to 95% non-condensing
Altitude	0-10,000 feet
Cooling	Convectional - non vented case

Mechanical

Case and Dimensions	5.08L x 3.05W x 1.67H (in) 129L x 77W x 40H (mm)
Case Material	Black 94V0 polycarbonate
Weight	13 ounces, 370 grams (excluding cord)

Connector

3

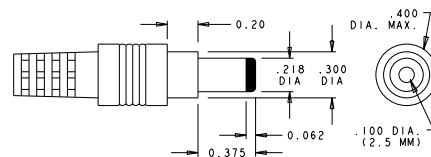

51

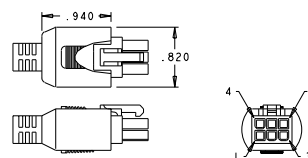

AULT INCORPORATED

7105 Northland Terrace | Minneapolis, Minnesota 55428 | USATEL (1) 763-592-1900

FAX (1) 763-592-1911 | E-MAIL info@aultinc.com | WEB www.aultinc.com

© Copyright 2002 Ault Inc.